

# FOR LEASE

## Bow River Professional

4411 16 Ave NW Calgary



For more information, please contact :

**DALE COUPRIE**

Senior Leasing Agent

Cell : (403) 852 4448 Fax : (403) 228 4439

[dcouprie@bowriverleasing.com](mailto:dcouprie@bowriverleasing.com)

**BOW RIVER PROPERTY MANAGEMENT AND LEASING**

B250 2210, 2nd Street, SW  
Calgary, AB. T2S 3C3

<http://bowriverleasing.com>

# Floor 1

Bow River Professional Center  
4411 16th Avenue NW

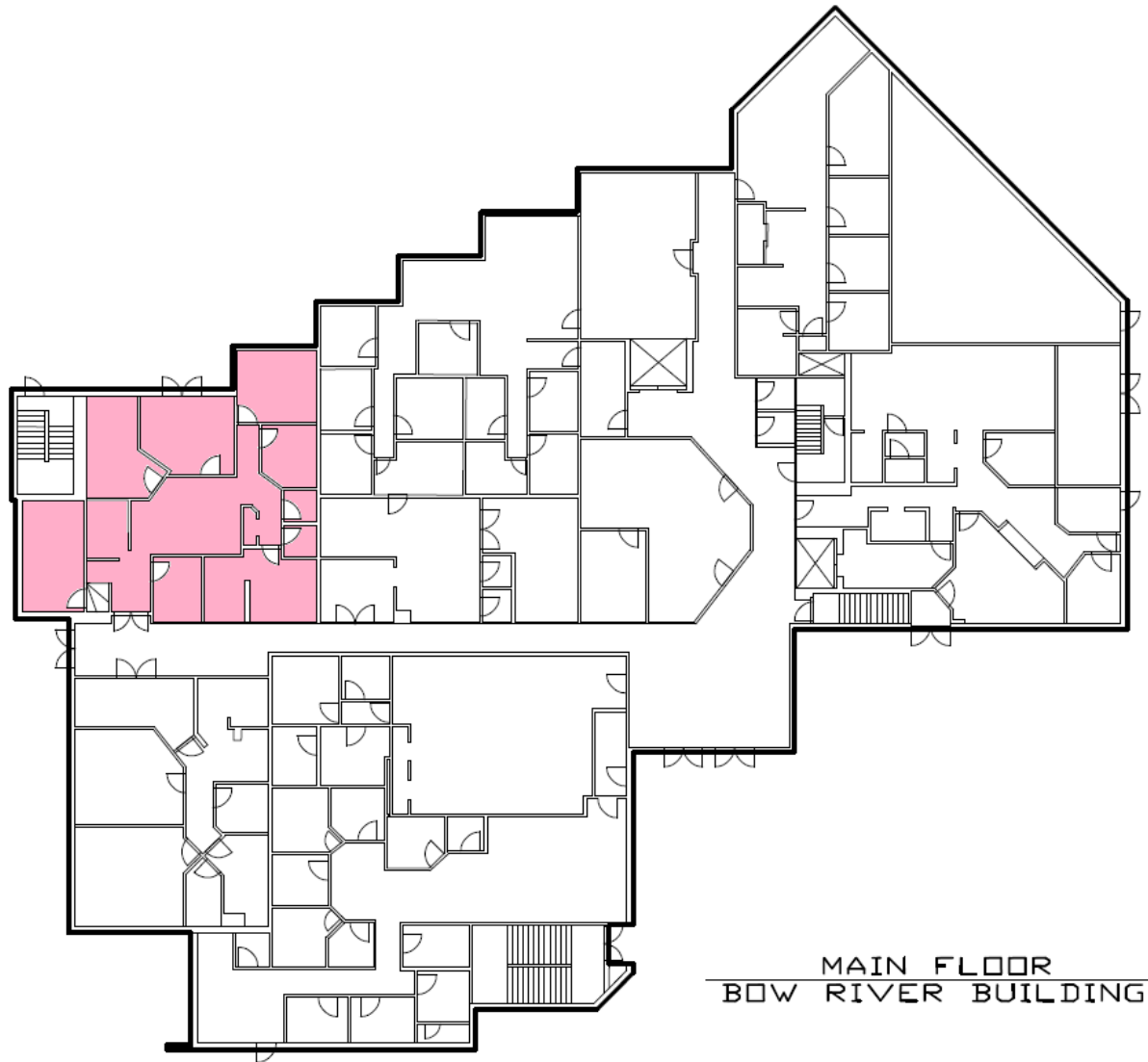

MAIN FLOOR  
BOW RIVER BUILDING

## HIGHLIGHTS

### Suite - 150

- \* New flooring and paint.
- \* Available window coverings.
- \* 7 rooms
- \* view : River
- \* 1839 sf

# Floor 2

Bow River Professional Center  
4411 16th Avenue NW

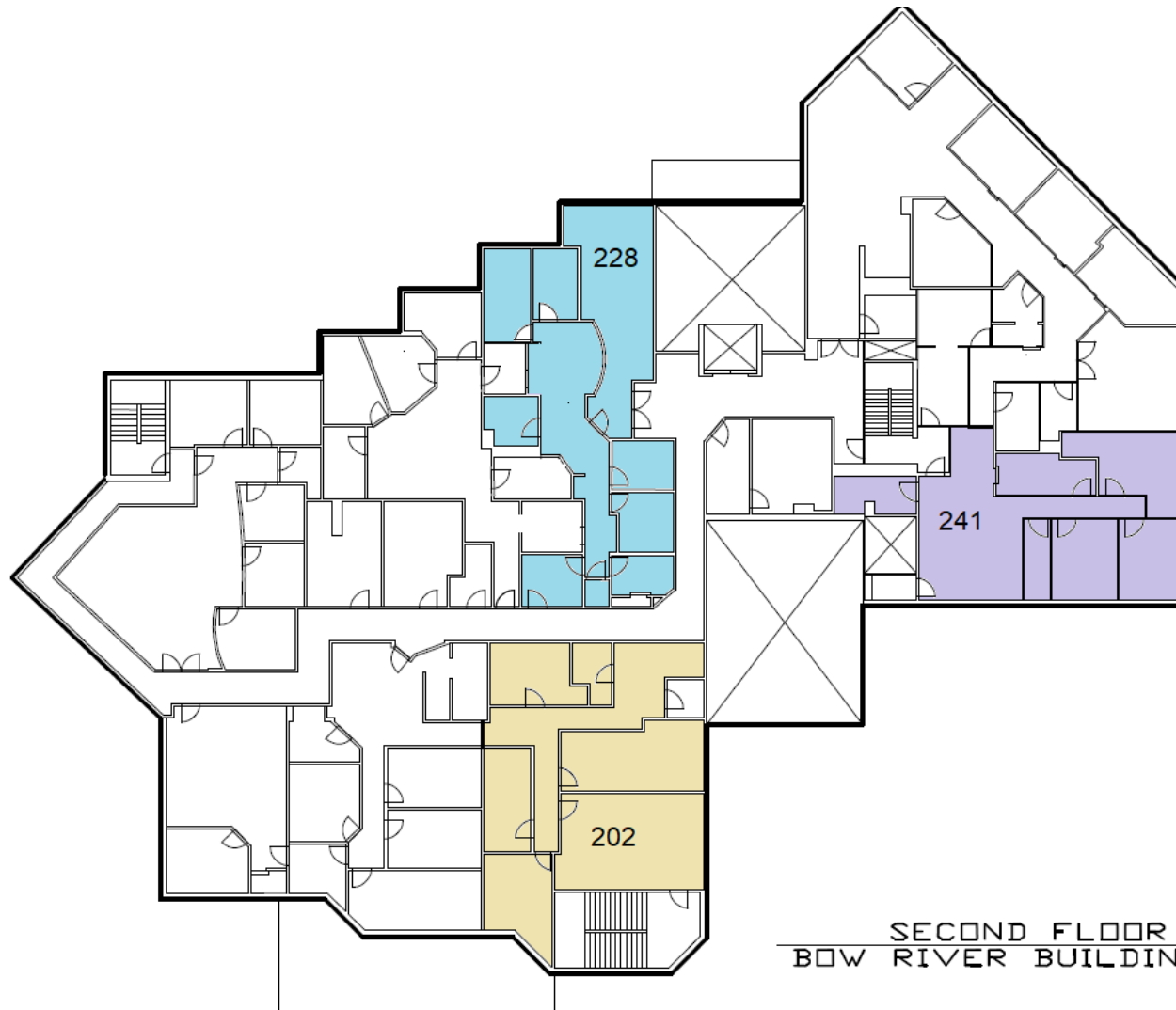

SECOND FLOOR  
BOW RIVER BUILDING

## HIGHLIGHTS

### Suite - 241

- \* 6 rooms
- \* 1665 sf

### Suite - 202

- \* 7 rooms
- \* view : Road
- \* 1894 sf

### Suite - 228

- \* 9 rooms
- \* Reception area
- \* Ensuite washroom(s)
- \* 1908 sf

# Floor 3

Bow River Professional Center  
4411 16th Avenue NW

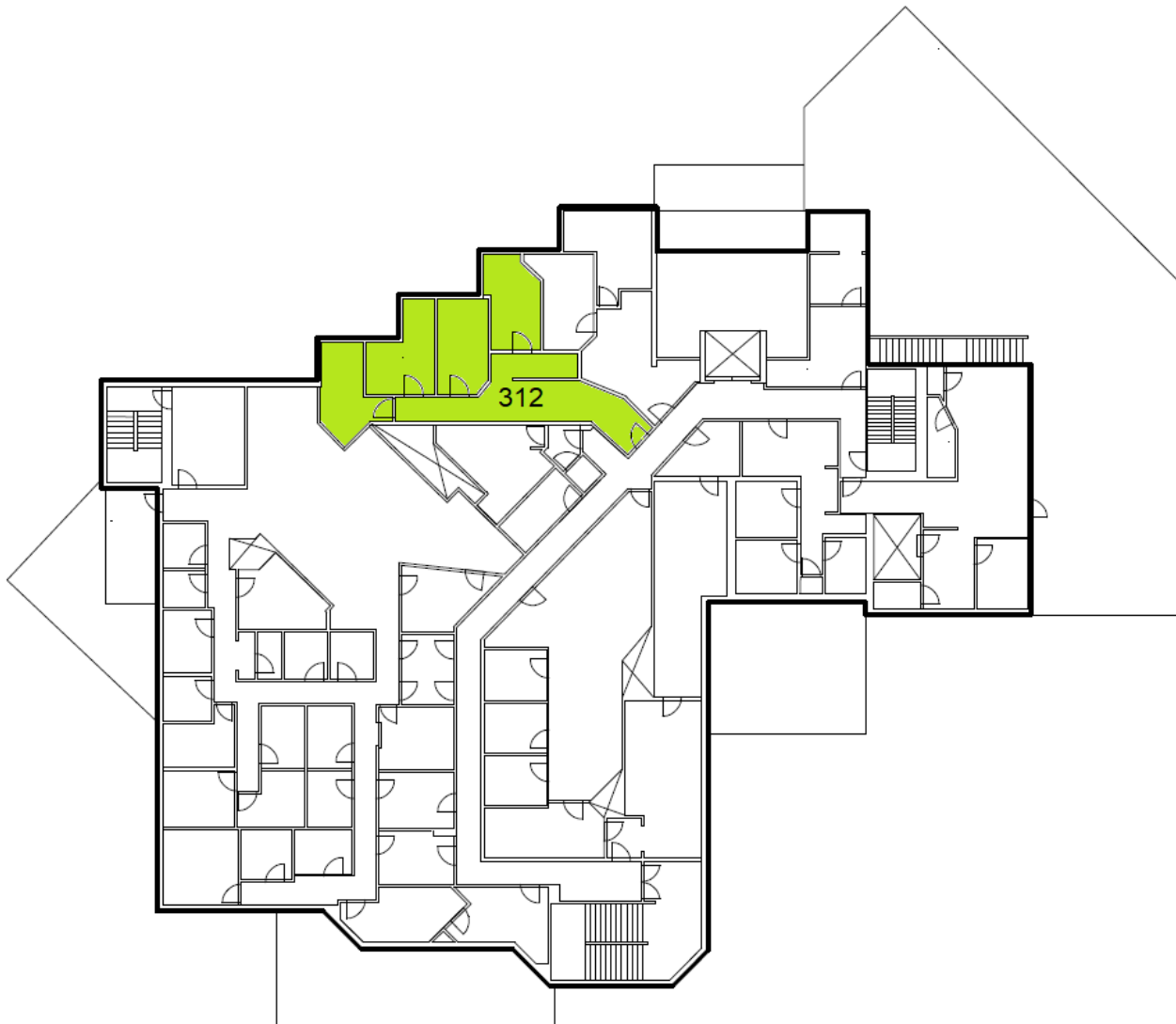

## HIGHLIGHTS

### Suite - 312

- \* 4 rooms
- \* view : River
- \* Storage
- \* Reception area
- \* 1100 sf